

FOR LEASE OFFICE & WAREHOUSE



2315 Meredith Lane | Santa Maria, CA

Well-maintained industrial units in busy Santa Maria Airport area. Centrally located industrial complex in easily accessible location. Units feature office area, roll-up door, H/C restroom.

Jerry Schmidt
805.928.2800 ext. 107
Jerry@PacificaCRE.com
Lic #0095042

Pat Palangi
805.928.2800 ext. 105
Pat@PacificaCRE.com
Lic #01108680

Mike Kelly
805.928.2800 ext. 113
Mike@PacificaCRE.com
Lic #01800988



2520 Professional Parkway | Santa Maria, CA 93455 | PacificaCommercialRealty.com

Information contained herein has been obtained from the owner of the property or from other sources deemed reliable. We have no reason to doubt its accuracy, but we do not guarantee it.

FOR LEASE 2315 Meredith Lane | Santa Maria, CA

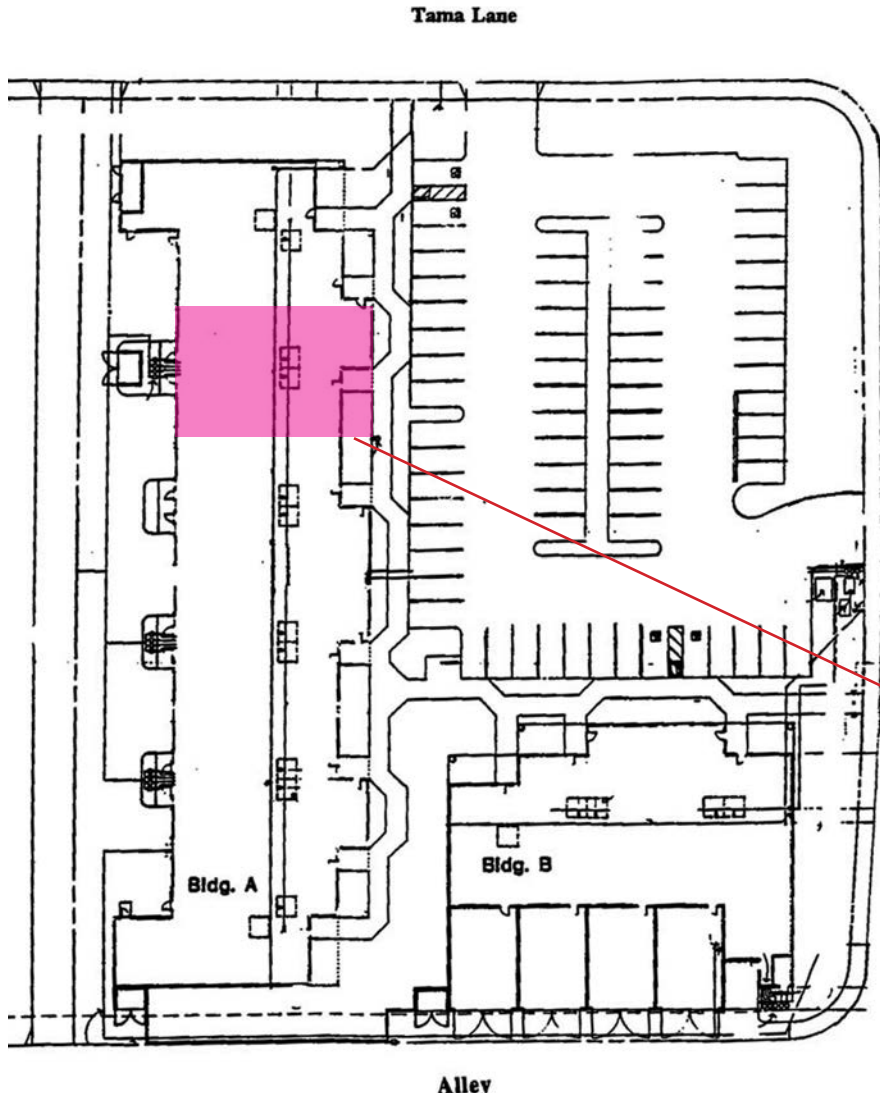

Property & Lease Details

- Suite C/D: 3,130 SF
\$0.90/SF, NNN
- Year Built: 1987
- Parking: 2.5/1,000 SF
- Roll-up Doors: 10' x 12'
- Construction: Split Faced Block
- Restrooms: Two
- HVAC
- Sprinklered
- Handicap Access
- Zoning: PD-M1



2520 Professional Parkway | Santa Maria, CA 93455 | PacificCommercialRealty.com

Information contained herein has been obtained from the owner of the property or from other sources deemed reliable. We have no reason to doubt its accuracy, but we do not guarantee it.